

CERTIFICATE OF LOCATION OF GOVERNMENT CORNER

EAST QUARTER Corner of Section 31, Township 106, Range 42, 5 P.M.

STATE OF MINNESOTA, County of MURRAY

At the corner location shown on the sketch:

- On _____ found a _____
DATE
- left monument as found, lowered monument, removed monument (explain)
- On 11-29-79 placed a 1/2"x15" REBAR 1' WEST OF CENTERLINE NORTH-SOUTH
DATE ROAD AND 2' NORTH OF FIELD DIVISION WEST

SKETCH OF REFERENCE TIES

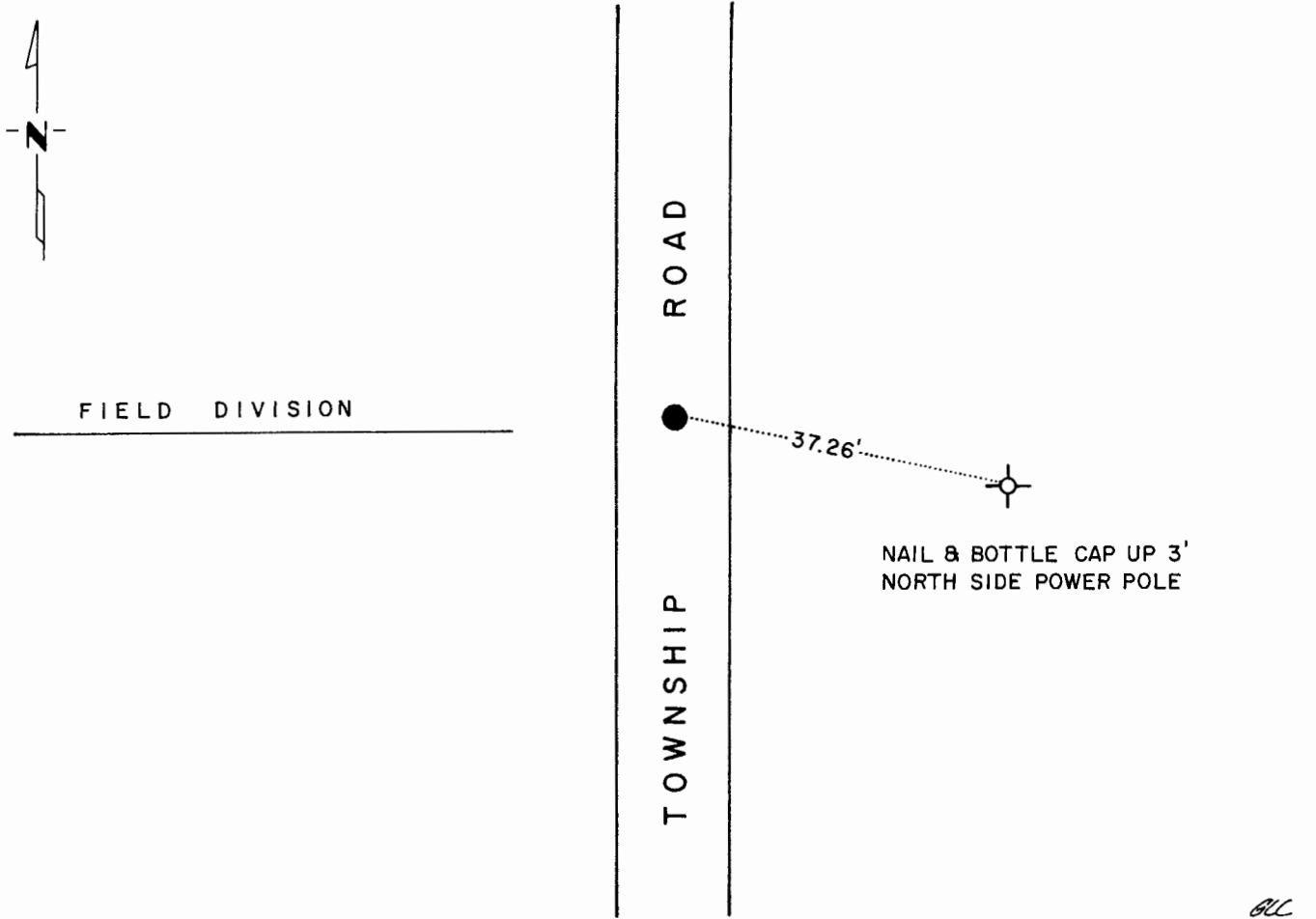

Statement of evidence relative to this corner location is on back of page.

I hereby certify that this document and the data contained herein was prepared by me or under my direct supervision.

Beck R. Evenden 7-23-80
SIGNATURE DATE

Registration No. 10516

- Land Surveyor, Professional Engineer
- County Surveyor, County Engineer

OFFICE OF THE REGISTER OF DEEDS

County of Murray

I hereby certify that this document was filed in the Reg. of Deeds office at 8:30 a.m. on the 9th day of October, A.D., 1981

Register of Deeds William W. Ohme

By _____, Deputy

DOCUMENT NO. 164696

Statement of Evidence:

MINNESOTA DEPARTMENT OF NATURAL RESOURCES, BUREAU OF ENGINEERING

East Quarter Corner of Section 31, Township 106, Range 42, 5th P.M.

Corner was originally established and a post was set by the Government Land Office in 1866. No original bearing trees were used. In June 1961, a Dept. of Natural Resources Engineering crew assumed the corner but the field notes don't state what was set or the procedure used. In August, 1973, said Dept. of Natural Resources contacted the Register of Deeds and County Engineer but no information was available. The DNR dug a 3.5'x6'x12' hole with a backhoe at the intersection of a north-south road and field division west; but found nothing. There is no field division east. John Eernisse, 52 more or less, owner of the northeast quarter of Section 31, said he knew of no established corner but that the field division west is assumed to be on the east-west quarter line.

In November, 1979, the DNR set the corner using lost methods as shown and described on this certificate. Lost methods were accepted here because the location using lost methods agrees well with existing occupation lines and because the occupation lines are not that precise.